

CF75A

dimensions

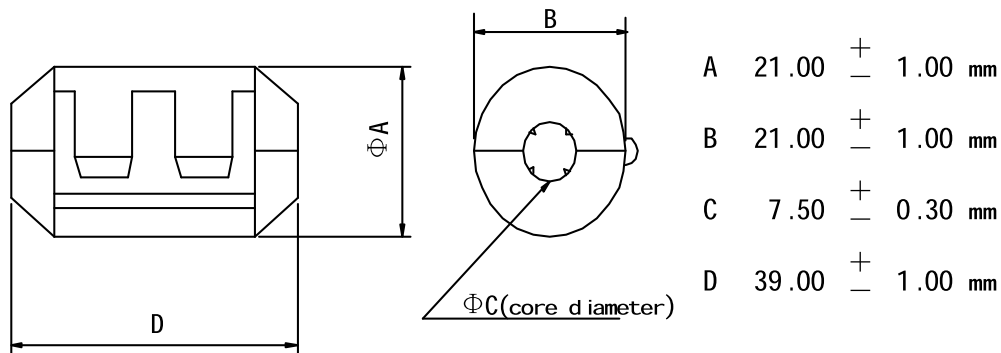

Z-F response

1. TEST INSTRUMENT: HP4286A
2. WINDING: 0.65 Φ X100 mm 2 U.E.W 1TS

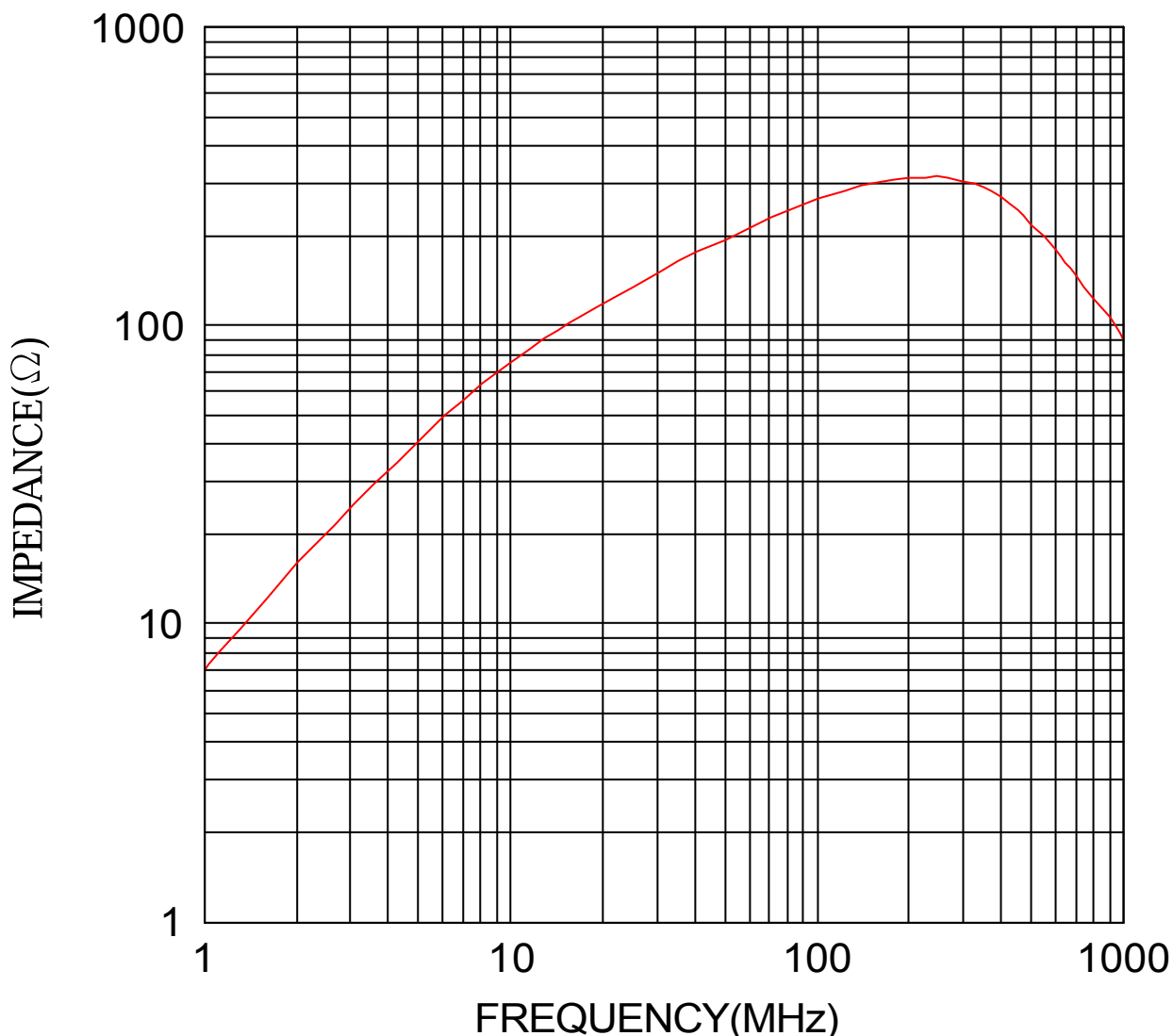

	1	5	10	25	50	100	200	300	400	500	600	700	800	900	1000
Z—	7	41	75	135	195	265	312	305	269	219	180	146	124	106	90

(DATA BETWEEN 500MHz AND 1000MHz ARE FOR REFERENCE ONLY)